

PAC-TITE COPING

FLAT VERSION

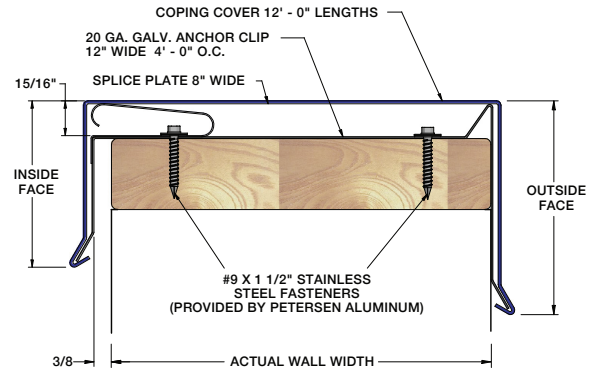

PRODUCT FEATURES

- ▶ Superior, efficient design for ease of installation
- ▶ Accommodates wall widths up to 34"
- ▶ Extensively tested for reliable long-term performance
- ▶ Snap-on design eliminates field-crimping
- ▶ Concealed splice plates provide watertight installation
- ▶ Pre-fabricated miters and accessories for proper system fit
- ▶ Custom fabrication available for job-specific details
- ▶ Stainless steel springs factory attached to 12" wide, pre-punched anchor clips
- ▶ Wide variety of colors, finishes and gauges
- ▶ Convenient 12' lengths
- ▶ Recyclable material
- ▶ Custom and radius capabilities available
- ▶ All fasteners, splice plates and anchor clips are included

MATERIALS

- ▶ 17 Stocked PAC-CLAD Finishes (22 gauge steel)
- ▶ 48 Stocked PAC-CLAD Finishes (24 gauge steel)
- ▶ 26 Stocked PAC-CLAD Finishes (.040 aluminum)
- ▶ 21 Stocked PAC-CLAD Finishes (.050 aluminum)
- ▶ 6 Stocked PAC-CLAD Finishes (.063 aluminum)
- ▶ Mill Finish Aluminum (.040, .050 & .063 aluminum)
- ▶ Clear and Colored Anodized (.040, .050 & .063 aluminum)

ACCESSORIES

- ▶ Miters (90 Degrees and Non-90 Degrees, Welded or Quicklocked)
- ▶ Transitions
- ▶ Endcaps
- ▶ Endwall Flashing

TESTING

- ▶ ANSI/SPRI/FM ES-1 Standard to comply with the International Building Code
- ▶ Factory Mutual approved
- ▶ Miami-Dade Approved to comply with the High Velocity Hurricane Zone of the Florida Building Code.

WARRANTY

A 20-Year, 120 mph Wind Warranty is available on orders to meet a project's specification. It provides a maximum of 20 years, 120 mph coverage for the repair or replacement of any portion of the roof edge system that has failed due to a defect in the supplied materials.